

CERTIFIED RECORD OF LAND CORNER MONUMENTATION

History of original corner establishment:
New Corner

*

DIAGRAM
T10S R31E
C1/4
+
S2

Description of corner evidence found:

Description of monument and accessories I establish to perpetuate the original location of this corner:

Set a 2x28" aluminum monument 14" in the ground in a mound of stone.

I establish new bearing trees:

A 14" P.Pine bears S 49° E, 19.6 ft, scribed C1/4S2BT.

A 7" Fir bears S 77° W, 37.3 ft, scribed C1/4S2BT.

T10S R31E
C1/4
+
S2
PLS1918
1988

New BTs have 3/4" brass washers marked PLS1918 attached to the BT blaze, faces and bands painted with red tree marking paint, and BT tags and Attention or Land Survey Monument signs. A steel fence post with Attention or Land Survey Monument sign is driven approximately 3-5 feet from the corner.

Sun Cadastral Survey, Cont No. 53-04H1-7-4011

Field Book: 4-29

Work accomplished: 8/17/88

Witnesses: Louise Parsons, Douglas Parsons

Job No.: 87221

PARSONS SURVEYING
1915 S.E. Stone Street
Corvallis, OR 97333
(503) 752-7515

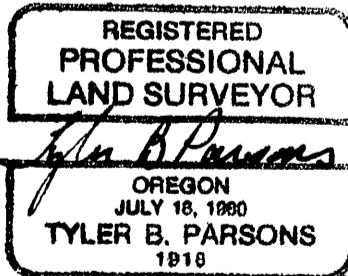

Office of COUNTY SURVEYOR County of GRANT
State of OREGON, I hereby certify that the within instrument was filed in this office
for record on the 7th day of Feb, 1989

Robert D. Bayetta
(COUNTY OFFICIAL) (DEPUTY)